

CABINET MEMBER FOR ENVIRONMENT – 25 MAY 2017

PROPOSED WAITING RESTRICTIONS, VARIOUS STREETS, BICESTER

Report by Director for Infrastructure Delivery

Introduction

1. This report presents objections and other comments received in the course of the statutory consultation on the proposals to introduce new and amend existing waiting restrictions in various streets in Bicester.

Background

2. Concerns over the obstruction of traffic and road safety as a result of on-street waiting at a number of locations within the town have been raised by local members and at the Bicester Traffic Advisory Committee, and in response officers identified - in consultation with local members – proposals for waiting restrictions. Following consideration of the responses to a formal consultation held in autumn 2016, amendments were made to some of the proposals after a joint review by officers and members, and a further consultation on all the proposed restrictions as shown in was carried out in March and April 2017.
3. Objections were received in respect of proposals for Bucknell Road, in the Kings Avenue area and in the Withington Road and Bernwood Road area as shown at Annexes 1, 2 and 3.
4. Other advertised at the same time were unopposed and can be dealt with under my delegated authority. Proposals for Brashfield Road and Granville Way were included in the above consultations but these require additional consultation with any objections presented to a future meeting.

Consultation

5. The formal consultation on the above carried out between 17 March and 14 April 2017. A public notice was placed in the Oxford Times, and notices placed on site in the immediate vicinity of the proposals. An email was sent to statutory consultees, including Thames Valley Police, the Fire & Rescue Service, Ambulance service, Town & District Councils and the relevant local County Councillors, and letters sent to nearby properties.

6. Annex 4 provides details of the objections received; copies of the full responses received are available for inspection in the Members' Resource Centre.

Objections and concerns

7. Seven objections were received in respect of the proposals for Bucknell Road, including three from residents of Field Street without off-street parking provision, for whom Bucknell Road is currently the nearest road with unrestricted parking. The objections related to the loss of parking for residents, and that the proposals would result in parking being transferred to other nearby roads which already have limited parking availability. Additionally there was a response from a resident of an adjacent side road requesting consideration of further restrictions to address a concern over the dangers posed by current parking opposite its junction with the side road.
8. The objections in respect of the proposals for the Kings Avenue area (2 objection), and in the Withington Road and Bernwood Road area (2 objections) were similarly on the grounds of the loss of parking for residents, and that parking would be transferred to other nearby roads which already have limited parking availability. One response from Rowan Road was to extend the restrictions further along that road, and there was another response seeking additional restrictions on a road that does not form part of these proposals.

Response to objections and concerns

9. It is acknowledged that some residents will have to make adjustments to their parking arrangements that may prove less convenient. However very careful consideration has been given to balancing the competing interests of residents so affected and others who are adversely affected by the current levels of parking by non-residents, including commuters.
10. In view of the above it is considered – also taking account of the very considerable input by local members into this review – that the proposals are appropriate and proportionate. Should the proposals be approved, monitoring will be carried out to assess their impact and the need for any modifications or additional measures.

How the Project supports LTP4 Objectives

11. The proposals would help facilitate the safe movement of traffic and pedestrians.

Financial and Staff Implications (including Revenue)

12. The appraisal of the proposals, consultation and preparation of all paperwork has been undertaken by Communities officers as part of their normal duties.

RECOMMENDATION

- 13. The Cabinet Member for Environment is RECOMMENDED to approve the implementation of the proposals as advertised and described in this report.**

OWEN JENKINS

Director for Infrastructure Delivery

Background papers: Consultation responses

Contact Officers: David Tole 07920 084148

May 2017

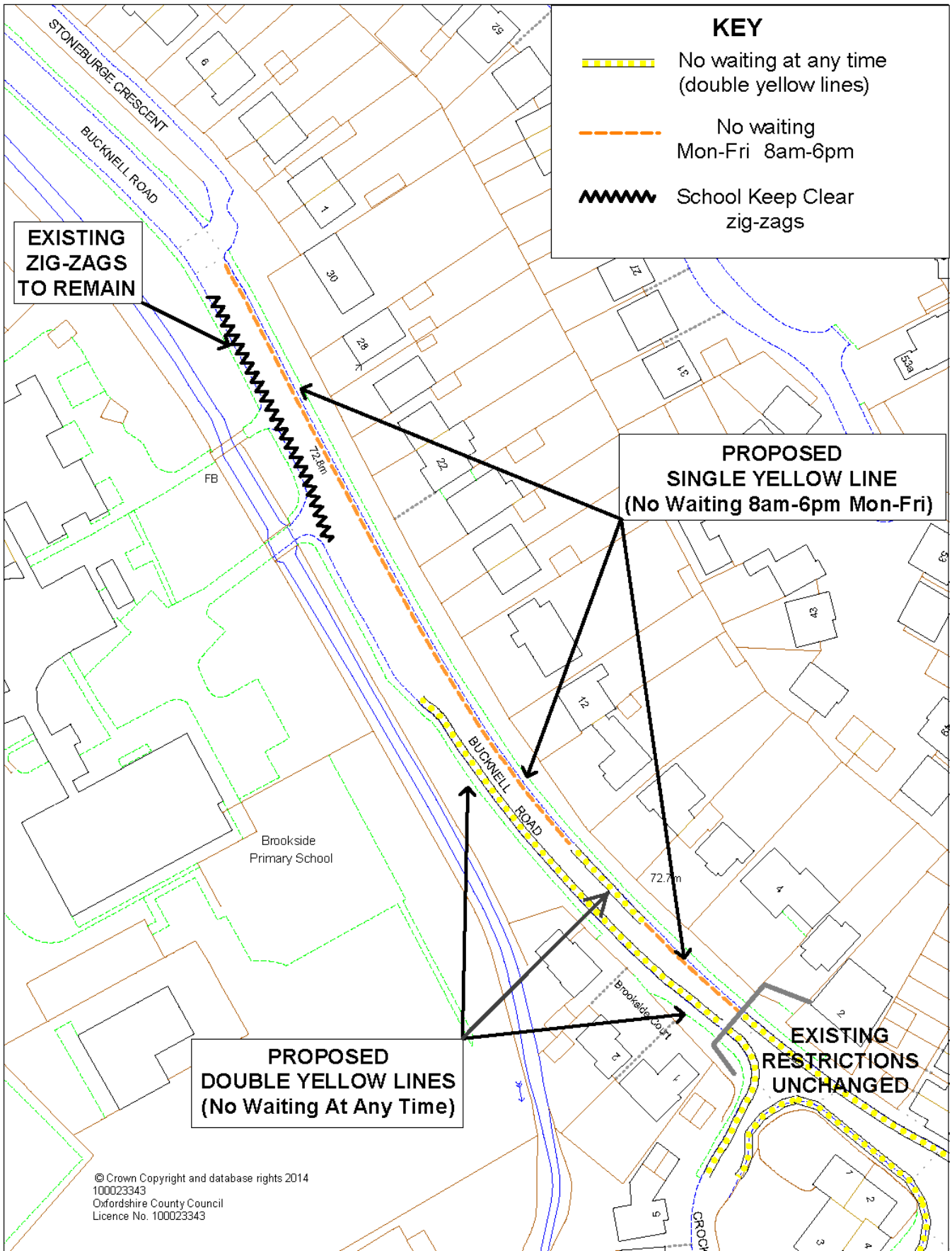

© Crown Copyright and database rights 2014
 100023343
 Oxfordshire County Council
 Licence No. 100023343





**PROPOSED PARKING RESTRICTIONS
 BUCKNELL ROAD, BICESTER**
 REVISED DECEMBER 2016

SCALE	1 : 1000
DATE	01/2016
DRAWING No.	
DRAWN BY	

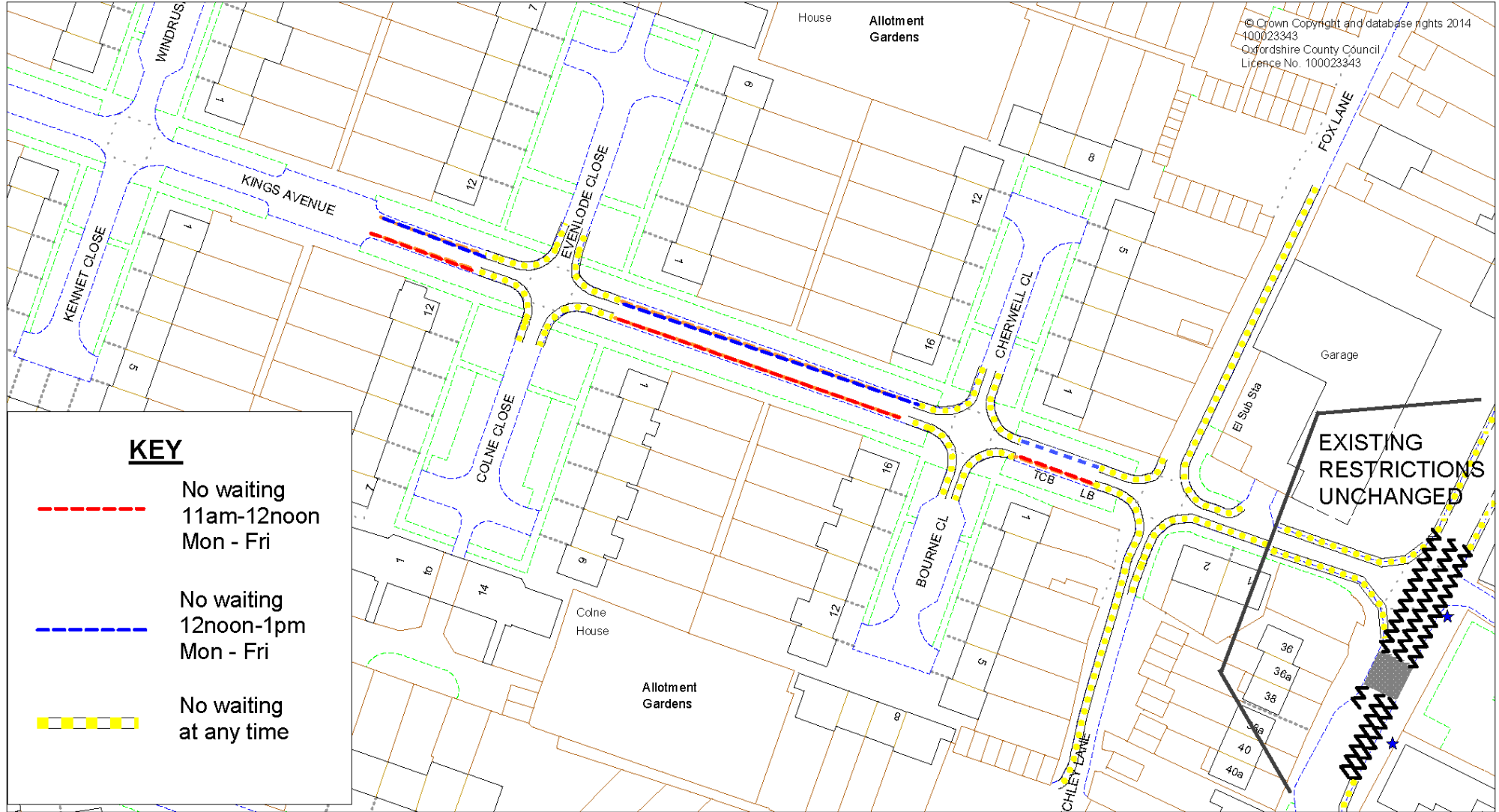
© Crown Copyright and database rights 2014
 100023343
 Oxfordshire County Council
 Licence No. 100023343



KEY

-  No waiting
11am-12noon
Mon - Fri
-  No waiting
12noon-1pm
Mon - Fri
-  No waiting
at any time



**OXFORDSHIRE
 COUNTY COUNCIL**
 ENVIRONMENT & ECONOMY
 www.oxfordshire.gov.uk



**PROPOSED PARKING RESTRICTIONS
 KINGS AVENUE AREA, BICESTER**

(Revised 1 December 2016)

SCALE	1 : 1000
DATE	1 December 2016
DRAWING No.	
DRAWN BY	

**PROPOSED
PARKING
RESTRICTIONS**

**WITHINGTON ROAD
BERNWOOD ROAD
CAMPBELL CLOSE**

BICESTER

© Crown Copyright and database rights 2014
100023343
Oxfordshire County Council
Licence No: 100023343



DRAWING TITLE

SCALE	1 : 1000
DATE	01/2016
DRAWING No.	
DRAWN BY	

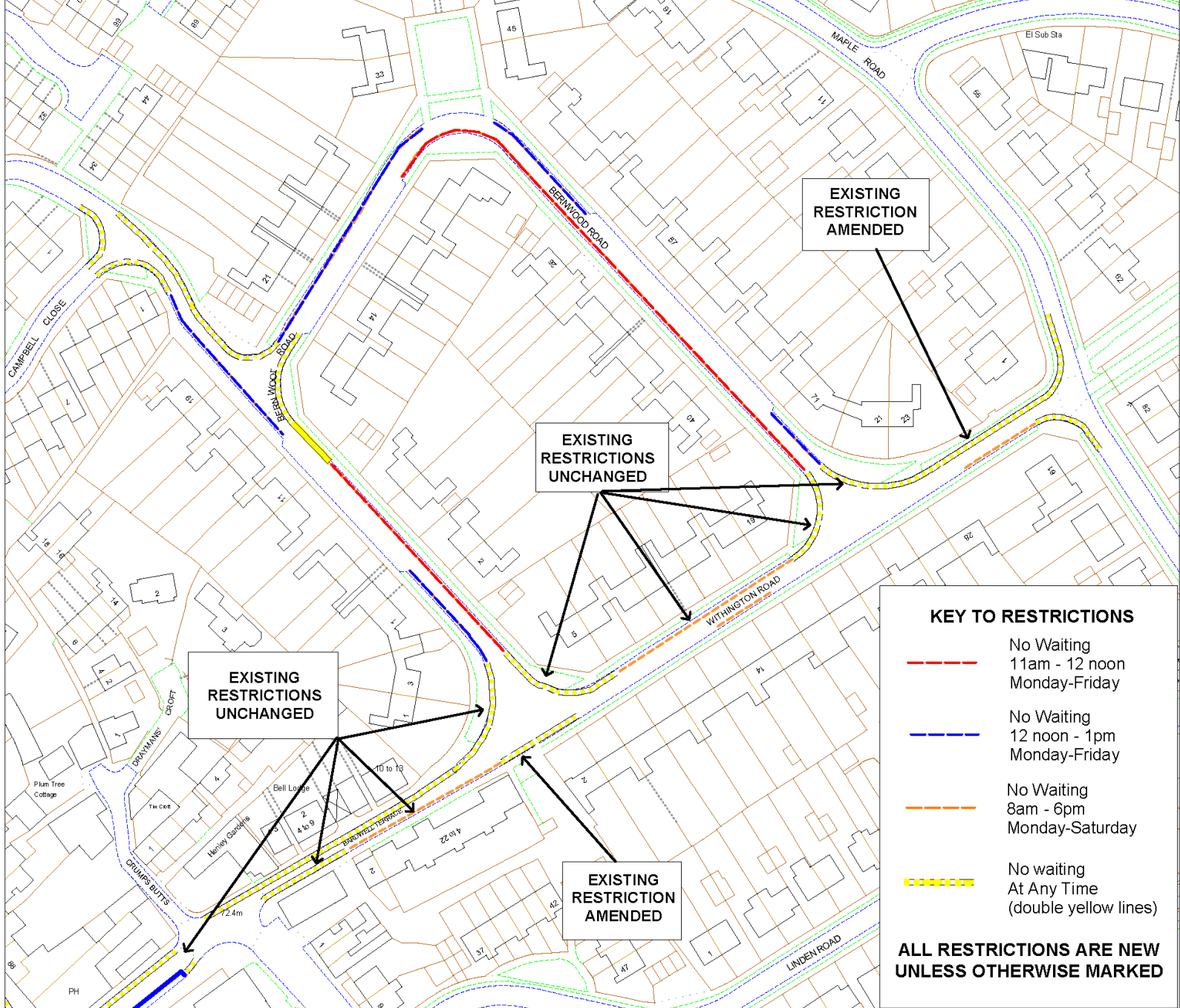

KEY TO RESTRICTIONS

- No Waiting
11am - 12 noon
Monday-Friday
- No Waiting
12 noon - 1pm
Monday-Friday
- No Waiting
8am - 6pm
Monday-Saturday
- No waiting
At Any Time
(double yellow lines)

**ALL RESTRICTIONS ARE NEW
UNLESS OTHERWISE MARKED**

RESPONSE IN RESPECT OF:	ID	RESPONDENT	FULL COMMENTS
Bucknell Road (Annex 1)	2	Resident , (Crockwell Close, Bicester)	<p>Object - I'm a resident of Crockwell Close and the impact of your changes to Bucknell Road will have a severe impact to the current flow of residential traffic to our close.</p> <p>We already have field street residents searching for spaces on our narrow close and the space is extremely limited especially when the road curves round adjacent to residents drives making it less than simple to reverse our of their driveway.</p> <p>I would support a no stopping order between peak times or some residents permit system to allow the close to manage the flow of traffic themsleves instead of being impacted by the several cars who regularly park on Bucknell road in the new zones where you will implement restrictions. this is at least 2-5 cars daily.</p>
Bucknell Road (Annex 1)	8	Resident, (Stoneburge Crescent, Bicester)	<p>Object - Bucknell Road Bicester Proposed Lines - This will just move the problem to Stoneburge Crescent, which is a private road. We struggle with Parents from Brookside school, and Teachers and Staff parking in the area, and we will never be able to get out of our Crescent. What about helping this by continuing the proposed lines passed the Crescent to protect us. and also make sure the lines are policed after to protect us!</p>
Bucknell Road (Annex 1)	14	Email Response Resident, (Bucknell Road, Bicester)	<p>Object My car has been able to park outside my property for the previous 18 years until OCC decided to give planning permission for the redevelopment of Bicester town centre, in turn moving cars from the centre car park to around the centre. In addition you gave, as detailed from my original letter dated 12th October 2016 attached, planning permission for 1, Chichester Close to build 2 No flats on the driveway of the property. I now have another 4 cars trying to park outside my</p>

CMDE5

			<p>property, as they do not use the parking as instructed within the planning of their property.</p> <p>As in my original letter, I have stated that I will happily convert the front of my house to a driveway if OCC are willing to give the planning permission and fully fund the conversion to a dropped kerb outside my property.</p>
Bucknell Road (Annex 1)	20	Email Response Resident, (Field Road, Bicester)	<p>Object: We are writing once again regarding the parking restrictions that are proposed for Bucknell Road, Bicester. Although we appreciate that changes have been made to the original proposals, from September 2016 we do not feel that they address our concerns and do not help our parking situation. We also feel that other residents, particularly from our street will be in the same situation. As before, although we understand the increased traffic and congestion around Bicester due to the increased number of cars going in and out of the housing areas and the town centre we would like to object specifically to the proposed changes to be made on Bucknell road.</p> <p>As property owners on Field Street we feel that these parking restrictions would:</p> <ol style="list-style-type: none"> 1. Leave us without anywhere to park our vehicle Monday-Friday 8am-6pm. 2. Decrease the value of our house due to future residents not being able to park a car nearby. 3. Hinder local residents and the safety of road users on Field Street. <p>We bought our house in 2012, with the understanding that we had on-street parking walkable to our property, we have since kept the car on Bucknell road and advice our guests to do the same. We cannot park anywhere else within reasonable distance as Field Street is a main road.</p> <p>As I said we do appreciate that you have attempted to reduce the parking by commuters and feel this will be beneficial to other road users but as a resident we do not only park our car there overnight. We often do not use our car during the day so these restrictions would leave us with nowhere to park from 8am-6pm weekdays. If we cannot park on Bucknell road we, along with other houses on our street may be forced to look into parking outside the front of our house, which would mean an increased</p>

CMDE5

			<p>disturbance on Field street, which is a main route in and out of the town and cars stopping to go up and down the large curb would stop the flow of traffic, which could provide undue risk to other road users.</p> <p>We therefore urge you to look at other options for residents, particularly of Field street as very few at Bucknell road end have off street parking. Would it be possible to have a resident parking permit to use on Bucknell road or another walkable street, such as North Street? North Street currently use resident only parking and from what I observe this seems successful and often has spaces. We are open to other suggestions and would gladly talk about this further but feel the current proposals are not suitable.</p>
<p>Bucknell Road (Annex 1)</p>	<p>21</p>	<p>Email Response Resident, (Field Road, Bicester)</p>	<p>Object I am writing to object to the proposed parking restrictions being imposed for Bucknell Road.</p> <p>By preventing people from parking their car in that road during the day, you are taking away my freedom and independence of being able to get around. I am registered as disabled and rely on having my car parked near to my house. As a resident of Field Street, as it is I am finding it harder and harder to do this because of the inconsiderate people who work nearby who park their car in Bucknell Road to avoid paying for their parking, but for you to take it away completely feels like a real kick to the residents.</p> <p>If we were to be given parking permits this would prevent those people from blocking the roads all the way back to Hudson Street and would allow the residents to have parking near to their homes. It would seem that a lot of other residents in similar positions in other roads have all been given the option of alternative parking arrangements but nothing has been given to the residents of Field Street. All of the residents of Bucknell Road have driveways and so these restrictions do not necessarily affect them but it does heavily affect us.</p> <p>A lot seems to be being done to improve Bicester and its roads but at the moment it seems it's the residents that are having to suffer the consequences. When North Street was closed off, those residents were given permits whilst the Field Street residents faced the increased noise caused from the increased traffic being forced down past the houses.</p>

CMDE5

			<p>I would like my points to be reviewed and a response as to how the Council may be willing to review the option of permits further or providing disabled parking. I broke my back in the Army and would like to think that I like so many other veterans won't be ignored and let down yet again.</p>
<p>Bucknell Road (Annex 1)</p>	<p>22</p>	<p>Email Response Resident, (Field Road, Bicester)</p>	<p>Object: I am writing again to object to the proposals ADK/DT.12.6.129 for PROPOSED PARKING RESTRICTIONS BUCKNELL ROAD, BICESTER.</p> <p>I live on Field Street and the ONLY parking near to my house is on Bucknell Road. So where exactly do you think people along Field Street can park???</p> <p>So far this year, I have seen my road listed as an area of high pollution (no huge surprise after North Street access was closed) and now I face severe parking issues.</p> <p>Also, my property value will be affected by a decision to put double yellow or single yellow lines here. Will you be compensating people?</p> <p>Instead of single or double yellow lines, why not have permits only for Field Street and Bucknell Road residents? The people living along Bucknell Road have large driveways and do not need to park on Bucknell Road. If the issue is Bicester North commuters and parents from the school, permits again should improve this.</p> <p>I still have no idea how you expect the parents to drop the kids to school.</p>
<p>Bucknell Road (Annex 1)</p>		<p>Resident letter, (Stoneburge Crescent, Bicester)</p>	<p>We are in full agreement that something needs to be done about this ASAP and welcome changes to improve the situation ... HOWEVER, the current proposal overlooks a significant issue of concern.</p> <p>This issue being: Vehicles parked on the bend opposite the entrance to Stoneburge Crescent. Our suggestion is that the current "School-Keep-Clear" Zig-Zag lines should be extended beyond the bend/junction/bus-stop.</p>

CMDE5

<p>Kings Avenue area (Annex 2)</p>	<p>10</p>	<p>Resident, (Bourne Close, Bicester)</p>	<p>Object - I wish to object strongly to the proposed parking restrictions, in particular, the proposed parking restriction along Finchley Lane, west side from Kings Avenue south wards for 55 Metres.</p> <p>Your plans for the proposed parking restrictions indicate that there will be a DYL imposed along Finchley lane. This restriction will prohibit us residents from parking at the rear of our properties. Four (4) of Six (6) Residents from Bourne Close have parking/Garages at the rear along Finchley lane. Your plans indicate the DYL on the West side of Finchley lane from the junction with Kings Avenue, southwards for a distance of 55 meter, this will run across these Four (4) access points. However, in your proposed plans you indicate that the east side of Finchley lane from the junction with Kings Avenue, southwards covers only a distance of 17 metres and the West side of Fox lane from the junction with Kings Avenue, northwards indicate no restrictions what so ever; showing that you have taken into consideration the access points and garages at the rear of these properties yet failed to do the same for the properties on the west side of Finchley lane.</p> <p>With 16 residential properties in Bourne Close and parking for only Six (6) vehicles in a close that has 13 vehicles, we as residents of the close would like to know where we are to park with the council now restricting us from parking near our homes and at the rear of our properties; considering that applications to lower kerbs within the close to easy the issues of inadequate parking have been rejected due to extreme restrictions and guidelines imposed by you the council.</p> <p>We feel the council has not provided us residents with adequate parking within the area. As a resident in the area of the proposed parking restrictions, these proposed restrictions will prohibit us residents from accessing/parking on our own properties.</p>
<p>Kings Road (Annex 2)</p>	<p>16</p>	<p>Email Response</p>	<p>Object Where do the people who actually live here park? Why should we have to move our cars every day for an hour? Just to solve problems created by bad approval of planning applications?</p>

CMDE5

<p>Withington Road / Bernwood Road area (Annex 3)</p>	<p>4</p>	<p>Resident, (Crumps Butts, Bicester)</p>	<p>Object - No provision has been made or considered for the nine residences of Crumps Butts. All of these homes have vehicles and only two have access to off-road parking. There is no other parking available except for Bernwood Road, with access to our homes along Campbell Close or the alley behind Campbell Close. Recently, I was quite ill for more than a week, I would not have been able to move my car if I had been forced to park in one of the restricted areas. I have chronic arthritis and often have to walk with a stick. The existing parking is poor, but the new proposal will make access to parking near my home extremely difficult, if not impossible.</p> <p>This proposal will force people like myself to park in either Campbell Close or Chichester Close, which will cause unpleasantness and inconvenience to the residents of those locations in addition to the residents of Crumps Butts. Many of the properties in Campbell Close have more than one vehicle that park on the roads, the same applies to left-hand side of Bernwood Road as one approaches Campbell Close.</p> <p>This is a ridiculous and poorly thought- out proposal that has not considered the wellbeing of all residents of the area and will cause untold upset and inconvenience for all of the residents in the area, not just Crumps Butts. Please find a better working solution that benefits all residents such as resident parking permits. This could be introduced quite easily and could be policed in much the same way as the proposed parking restrictions would be.</p> <p>With respect, I really do not see how councillors can make any decision when they have not visited the area and carried out a full assessment of the existing problems and potential solutions.</p>
<p>Withington Road / Bernwood Road area (Annex 3)</p>	<p>19</p>	<p>Email Response Resident, (Bernwood Road, Bicester)</p>	<p>Object I would like to object to the parking restrictions proposed for Bernwood Road unless there is going to be a permit option so that I can park my car outside my house without worrying about moving it for 1 hour a day.</p>

CMDE5

<p>Withington & Bernwood Road (Annex 3)</p>		<p>Resident letter, (Withington Road, Bicester)</p>	<p>Questions and Concerns :</p> <ol style="list-style-type: none"> 1. (Bardwell Terrace) - Querying why only on a single yellow line on the narrowest/busiest/dangerous road on the estate. 2. (2 Withington Rd) - why double yellow lines right across my drive- agree to halfway across allowing me to park outside my own home. 3. (14-16 Withington Rd) - not sure what colour- but why is it there. 4. (20-26 Withington Rd) - why no double yellow lines like outside no. 2 Withington STILL a junction and also nearer to the school. <p>Blue/Orange lines around Withington/Bernwood with 1 hour interval around mid-day - this may help with workers parking all day but Sainsbury's shift workers will still be ok.</p> <p>Also how do residents cope when unable to park outside their own home. Also may main concern- WHO IS GOING TO POLCE THIS OPERATION - why not concentrate on the pot holes & build more car parks or just bring in FREE PARKING like Witney that is also in Oxfordshire. BUT maybe this is too late as we have no shops anyway.</p>
<p>Rowan Road</p>	<p>17</p>	<p>Email Response</p>	<p>We really do not want the only on street parking on Rowan Road right outside our house!!! We have already had to call the police several times because people have parked across our drive or even on our drive!</p> <p>Rowan Road is a small road it is often the case that larger delivery vehicles cannot get passed parked cars</p> <p>Also these parking spots are often used for drug dealing - that's just not acceptable.</p> <p>Please put double yellow lines both sides of Rowan road or at least the full lrength of our property</p>
<p>No proposals included in consultation</p>	<p>11</p>	<p>Resident, (Buckingham Crescent, Bicester)</p>	<p>Buckingham Crescent is, at times, a nightmare for parking. I realise that having a pizza takeaway chain there is obviously going to attract a certain level of nuisance parking, but there are other factors to consider. This is basically a cul-de-sac and therefore a bottleneck during busy hours. Double yellow lines are ignored, parking the other side on the grass area. People parking to use the bus stop, train station, and</p>

CMDE5

			<p>shops on the other side of Buckingham Road are adding to local frustrations. People park on grass verges and even across driveways despite clearly having lowered curbs and being a private property.</p>
--	--	--	--